

ACCELEROMETER

ACCELEROMETER

The Accelerometer has been designed for dynamic structural testing in tough field conditions. These accurate, rugged, and fully-weatherproofed units can be installed very quickly and are available in ranges between $\pm 2g$ and $\pm 100g$.



APPLICATIONS

- Cable force measurements
- Structure vibration testing & monitoring
- Earthquake monitoring/detection
- Structure modal analysis
- Vehicle dynamics

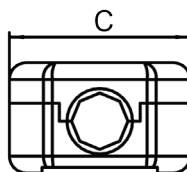
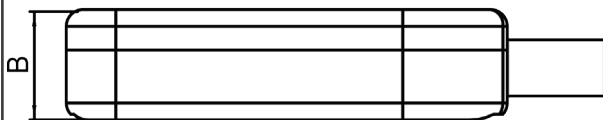
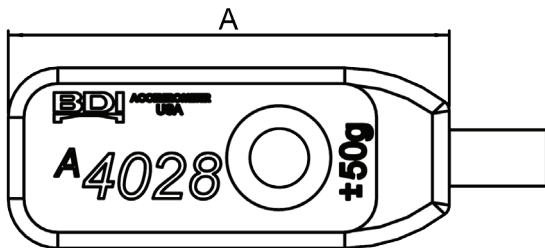
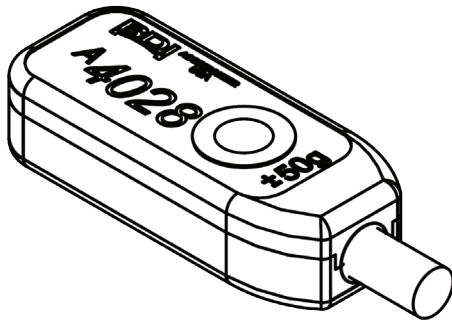

FEATURES

- Completely reusable
- Water and weather resistant to IP67 rating
- Nitrogen gas damped
- Compatible with most data acquisition systems
- Various mounting options available
- Field-grade instrumentation cable, any length available
- N.I.S.T. traceable calibration
- High output sensor
- Responds from rated frequency down to 0 Hz



MODEL	A1221L-002	A1221L-005	A1221S-010	A1221S-025	A1221S-050	A1221S-100
RANGE (G)*	±2	±5	±10	±25	±50	±100
FREQUENCY RESPONSE [NOMINAL, 3DB] (HZ)	0-400	0-600	0-1,000	0-1,500	0-2,000	0-2,500
DIFFERENTIAL SENSITIVITY (MV/G)	1,000	400	160	80	40	20
OUTPUT NOISE, DIFFERENTIAL [RMS, TYPICAL] (MG/VHZ)	5	7	10	25	50	100
MAX MECHANICAL SHOCK [0.1 MS] (G)	2,000		5,000			
TYPE	Micro-machined capacitive sense element					
DAMPING	Nitrogen Gas Damped					
EXCITATION VOLTAGE (VDC)	+5.0 VDC (±0.5%)					
POWER RATING	<div>MAX: 75mW</div> <div>TYPICAL: 25mW</div> <div>INTELLIDUCER: 13mW @ +5.0 Vdc**</div>					
OUTPUT IMPEDANCE	90 Ω					
DIFFERENTIAL OUTPUT	± 2.0 VDC Full Scale Output					
OPERATING TEMPERATURE	-67°F to +257°F (-55°C to +125°C)					
SIZE (A X B X C)	0.80 in x 1.95 in x 0.49 in (20.3mm x 49.5mm x 12.4mm)					
WEIGHT	0.12 lbs. (54 grams)					
HOUSING	6061-Aluminunum					
WEATHER PROOFING	IP67 Rated					
MOUNTING	BDI Mounting Tabs and adhesive, mechanical connection					
COMPLIANCE	RoHS ESD protection conforming to IEC 6100-4-2					

CE



* other ranges available upon request

** Intelliducer connectors operate at +5.0 Vdc only.

